

**Proposed Project at Mouza-Katwa, J.L. No-21, L.R. Khatian No-10713, L.R. Plot No-755, 761, 762, 763, Ward No-5, under Katwa Municipality, P.O. & P.S.- Katwa, District-Purba Bardhaman**

---

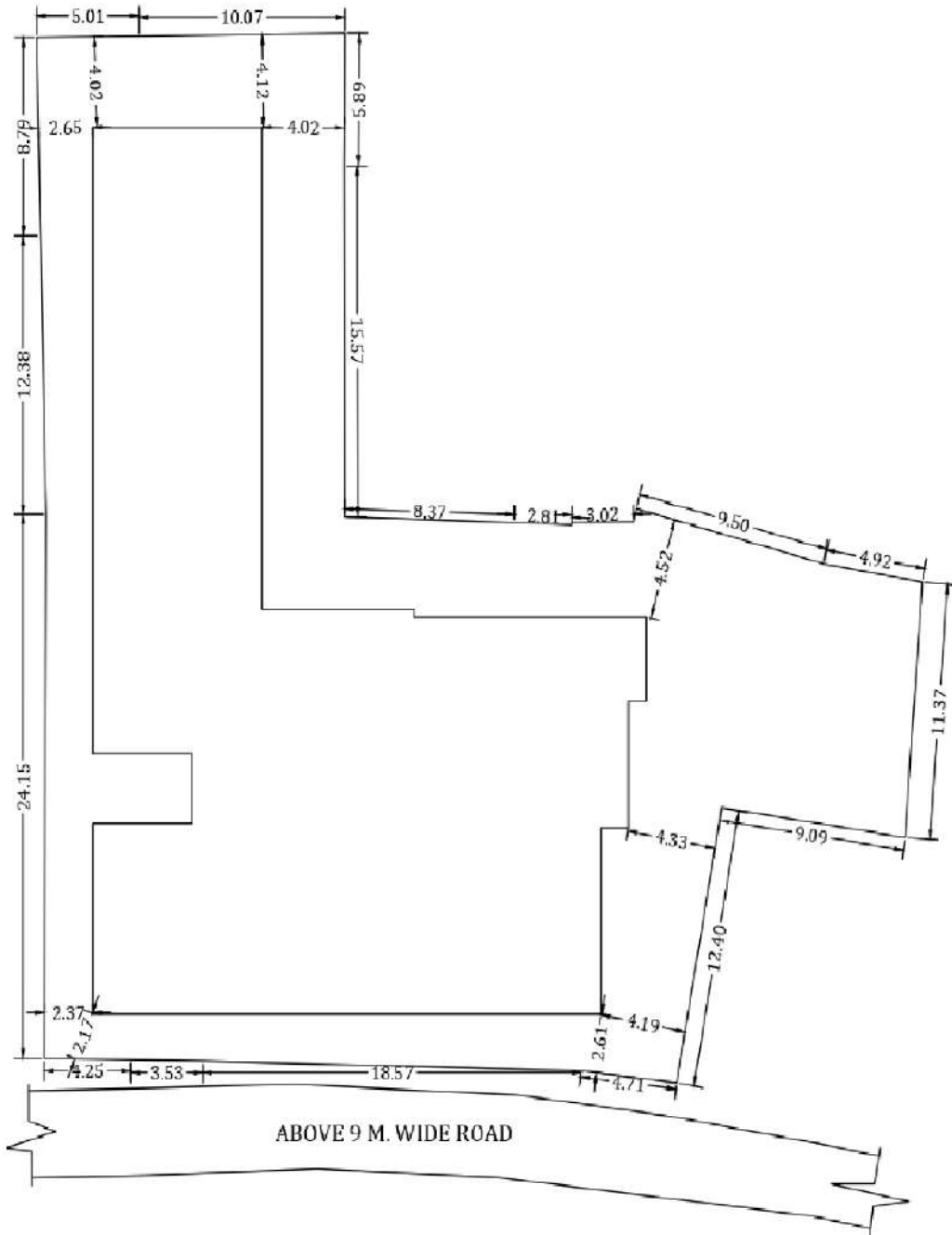

**LATITUDE : 23.013195**  
**LONGITUDE : 87.530707**

**GITA RANI CONSTRUCTION**  
Rahul Sinha.  
**PARTNER**

---

**SIGNATURE OF OWNER**